

C-Tap Connectors for Copper Conductor

Positive, all-around compression with low resistance and high pull-out values.

C-Taps for 600V Applications

- Ideal for pigtailing, two-way splicing or tapping to an unbroken continuous main
- Heavy reinforcing ribs help locate compression dies and strengthen compressed joint

Material: High-Conductivity Wrought Copper

Finish: Plain

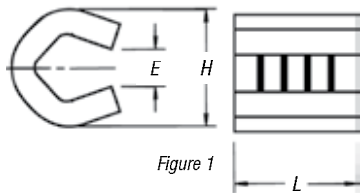

Figure 1

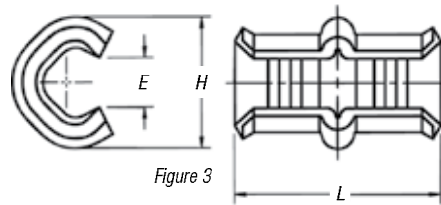

Figure 3

"E" represents gap in side

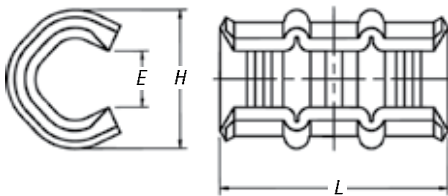

Figure 2



| CAT. NO. | FIG. NO. | DIMENSIONS (IN.) | | | COLOR KEY |
|----------|----------|------------------|--------|--------|-----------|
| | | L | H | E | |
| 54705 | 1 | 5/16 | 3/16 | 7/64 | RED |
| 54710 | 1 | 3/16 | 7/16 | 3/64 | BLUE |
| 54715 | 1 | 3/16 | 3/8 | 1/64 | GRAY |
| 54720 | 2 | 1 1/32 | 1 1/16 | 7/32 | BROWN |
| 54725 | 2 | 1 1/32 | 1 3/16 | 1/4 | GREEN |
| 54730 | 2 | 1 1/32 | 2 1/32 | 7/32 | PINK |
| 54735 | 3 | 1 1/16 | 1/8 | 2 1/64 | BLACK |
| 54740 | 3 | 1 1/16 | 3 1/32 | 2 3/64 | ORANGE |
| 54745 | 3 | 1 1/16 | 1 1/16 | 1 3/32 | PURPLE |
| 54750 | 3 | 1 1/16 | 1 3/16 | 1 1/32 | YELLOW |

UL[®] approved for direct burial.

For covers, see **page F-48**.

Taps can be supplied tin-plated. Add suffix "TP" to any catalog number (i.e., 54725TP).

Typical Cable Combinations

| MAIN | BRANCH | | | | | | | |
|------------------|------------------|------------------|-----------------|-----------------|---------|---------|---------|----------|
| | #12 SOL. OR STR. | #10 SOL. OR STR. | #8 SOL. OR STR. | #6 SOL. OR STR. | #4 STR. | #2 STR. | #1 STR. | 1/0 STR. |
| #10 Sol. or Str. | 54705 | 54710 | 54715 | 54715 | 54720 | 54730 | 54735 | 54740 |
| #8 Sol. or Str. | 54710 | 54715 | 54715 | 54720 | 54720 | 54730 | 54735 | 54740 |
| #6 Sol. or Str. | 54715 | 54715 | 54720 | 54720 | 54725 | 54730 | 54735 | 54740 |
| #4 Str. | 54720 | 54720 | 54720 | 54725 | 54730 | 54735 | 54740 | 54740 |
| #2 Str. | 54730 | 54730 | 54730 | 54730 | 54735 | 54740 | 54745 | 54745 |
| #1 Str. | 54735 | 54735 | 54735 | 54735 | 54740 | 54745 | 54745 | 54750 |
| 1/0 Str. | 54740 | 54740 | 54740 | 54740 | 54740 | 54745 | 54750 | 54750 |
| 2/0 Str. | 54745 | 54745 | 54745 | 54745 | 54745 | 54750 | 54750 | |
| 3/0 Str. | 54750 | 54750 | 54750 | 54750 | 54750 | 54750 | | |

Tooling: **pp. F-80-F-100**

Die Selector Chart: **p. F-101-F-104**

C-Tap Connectors for Copper Conductor

Easy to work with in tight spaces.

C-Taps — Large Size for 600V Applications

- More economical than other taps and split bolts in terms of purchase, inventory, installation time, insulation and maintenance
- Color-coded for easy matching with proper die
- Barely larger than conductor insulation once installed

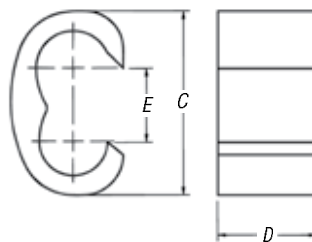

Material: High-Conductivity Wrought Copper

Finish: Plain



| CAT. NO. | WIRE SIZE | | DIMENSIONS (IN.) | | | INSTALLING DIE | | DIE CODE | NO. OF CRIMPS | COLOR KEY |
|----------|-----------|-------------------|-------------------------------|-------------------------------|-------------------------------|----------------|----------|----------|---------------|-----------|
| | MAIN | BRANCH | C | D | E | TOOL | CAT. NO. | | | |
| 54755 | #1 AWG | #1 AWG | 1 ¹ / ₆ | ¾ | ½ | TBM14M | 15512 | 76 | 1 | BLUE |
| | 1/0 AWG | 1/0-#2 AWG | | | | TBM15I | 15512* | 76 | | |
| | 2/0 AWG | 2/0-#4 AWG | | | | TBM12 | TBM12D-4 | 76 | | |
| | 3/0 AWG | 1/0-#6 AWG | | | | 13100A | 15512 | 76 | | |
| 54760 | 4/0 AWG | #1-#8 AWG | 1 ¹ / ₆ | ¾ | ½ | TBM14M | 15506 | 87H | 2 | BROWN |
| | 2/0 AWG | 2/0-#1 AWG | | | | TBM15I | 15506* | 87H | | |
| | 3/0 AWG | 3/0-#3 AWG | | | | TBM12 | TBM12D-3 | 87H | | |
| | 4/0 AWG | 4/0-#4 AWG | | | | 13100A | 15506 | 87H | | |
| 54765 | 250 kcmil | #1-#8 AWG | 1 ¹ / ₆ | 1 | ¾ | TBM14M | 15505 | 99H | 2 | PINK |
| | 2/0 AWG | 2/0-#1 AWG | | | | TBM15I | 15505* | 99H | | |
| | 3/0 AWG | 3/0-#2 AWG | | | | TBM12 | TBM12D-2 | 99H | | |
| | 4/0 AWG | 4/0-#4 AWG | | | | 13100A | 15505 | 99H | | |
| 54770 | 300 kcmil | 2/0-#8 AWG | 1 ¹ / ₆ | 1 | ½ | TBM14M | 15515 | 106H | 2 | BLACK |
| | 4/0 AWG | 4/0-2/0 AWG | | | | TBM15I | 15515* | 106H | | |
| | 250 kcmil | 250 kcmil-#1 AWG | | | | TBM12 | TBM12D-2 | 106H | | |
| | 300 kcmil | 4/0-#4 AWG | | | | 13100A | 15515 | 106H | | |
| 54775** | 350 kcmil | 3/0-#6 AWG | 1 ¹ / ₆ | 1 | ¾ | TBM14M | 15504 | 115H | 2 | YELLOW |
| | 250 kcmil | 250 kcmil | | | | TBM15I | 15504* | 115H | | |
| | 300 kcmil | 300 kcmil-3/0 AWG | | | | TBM12 | TBM12D-1 | 115H | | |
| | 350 kcmil | 350 kcmil-1/0 AWG | | | | 13100A | 15504 | 115H | | |
| | 400 kcmil | 300 kcmil-#2 AWG | | | | | | | | |
| 54780 | 450 kcmil | 250 kcmil-#4 AWG | 2 ¹ / ₆ | 1 ¹ / ₄ | ¾ | TBM14M | 15603 | 125H | 2 | N/A |
| | 500 kcmil | 250 kcmil-#6 AWG | | | | TBM15I | 15603 | 125H | | |
| | 350 kcmil | 350 kcmil-4/0 AWG | | | | | | | | |
| | 400 kcmil | 400 kcmil-2/0 AWG | | | | | | | | |
| 54785 | 450 kcmil | 450 kcmil-#1 AWG | 2 | 2 | 1 | TBM15I | 15603 | 125H | 3 | N/A |
| | 500 kcmil | 500 kcmil-#2 AWG | | | | | | | | |
| 54790 | 750 kcmil | 750 kcmil-4/0 AWG | 2 ¹ / ₆ | 2 | 1 ¹ / ₆ | TBM15I | 15603 | 125H | 3 | N/A |

UL approved for direct burial.

For covers, see p. F-48

Taps can be supplied tin-plated. Add suffix "1P" to any catalog number (i.e., 547251P).

* Cat. No. 15500-TB adapter required if using TBM15I and 155XX series dies.

** #6 AWG branch must be doubled.

Tooling: pp. F-80-F-100

Die Selector Chart: p. F-101-F-104